

Our Products

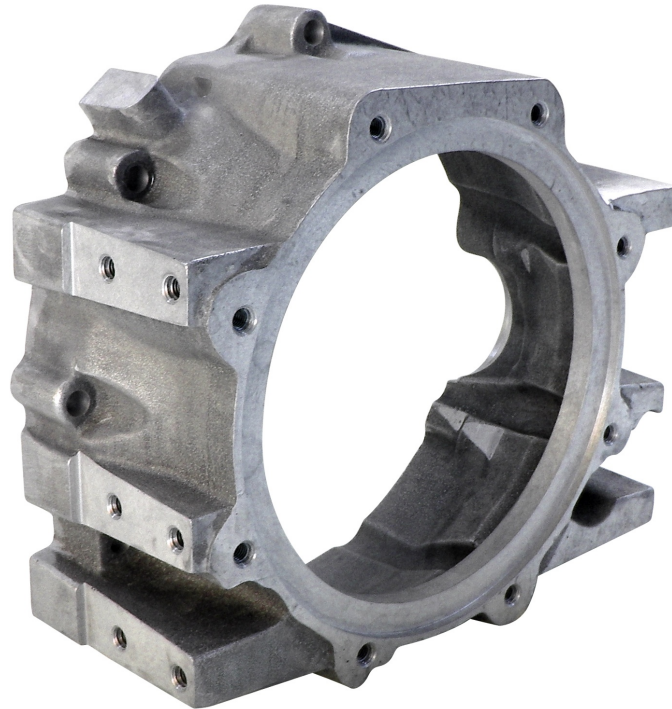

Flywheel housing VW918



VW918 Flywheel Housing Specifications:

- SAE6 flange (other SAE flywheel adapter plates available)
- Aluminium (lightweight)
- Helicoil fixing points
- Available with engine speed signal pick up point
- 20° Installation angle
- Starter motor mounting point

Suitable for use with
D 1.9 and 1.8 Spark
ignition engines.

VOLKSWAGEN
Powersystems & Components

Contact Details

Marshall's Industrial Ltd.
Beadle Estate
Hithercroft Road
Wallingford
Oxfordshire
OX10 9DG
UK

Telephone: +44 (0)1491 834666
Facsimile: +44 (0)1491 839777
Email: sales@mi-uk.com
mi-uk.co.uk

Our Products

Flywheel housing VW918

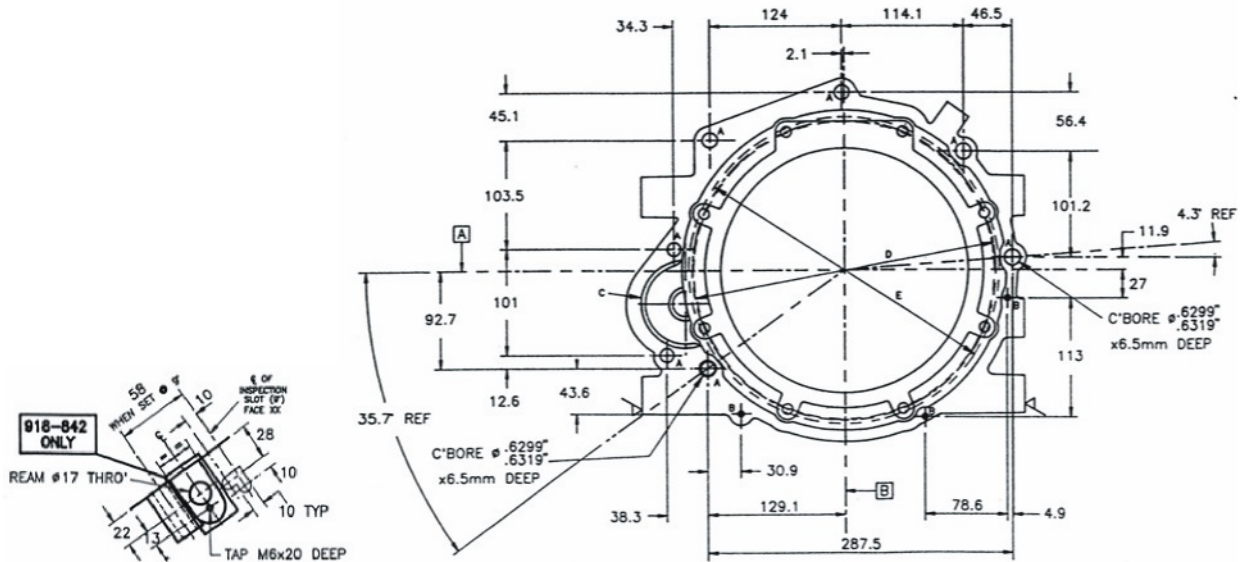

ENGINE MOUNTING SIDE

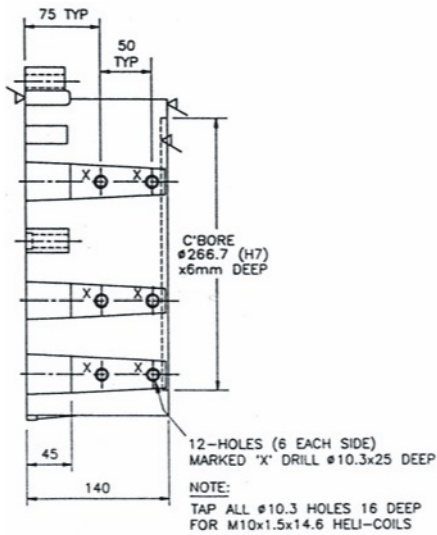

SIDE VIEW

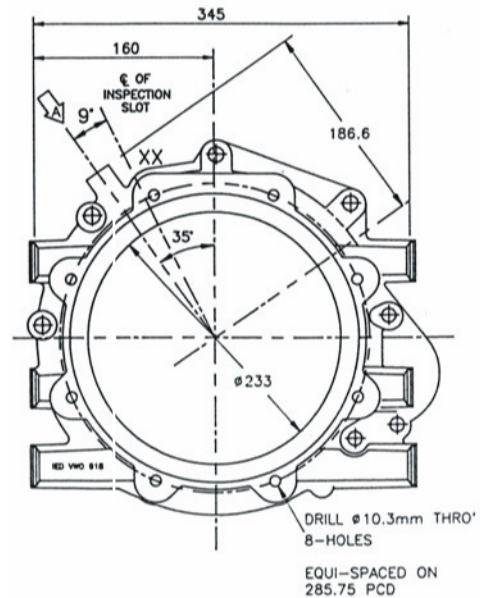

GEARBOX MOUNTING SIDE